



Oaklands Farm Solar Park

Consultation Report

Appendix 11.12 - Copy of Poster Communicating SoCC Publication

January 2024

Applicant: Oaklands Farm Solar Ltd

Document Reference: EN010122/APP/5.2

Date: January 2024

Pursuant to: APFP Regulation: 5(2)(q)

Author: Thirty4/7 Communications Ltd

Contents

1. Poster locations	3
2. Copy of Poster	4
3. Example photos of posters in situ.....	5
Stapenhill Tesco Express	5
The Co-Operative Food, Barton Under Needwood	6
Tesco Superstore – Burton on Trent	7
Barton Under Needwood Community Library	8

1. Poster locations

The Co-operative Food - Barton-under-Needwood	Crowberry Ln	Barton-under-Needwood	Burton-on-Trent
Barton Under Needwood Community Library	Dunstall Road	Barton-under-Needwood	Staffordshire
Tesco Superstore – Burton-on-Trent	St Peter's Bridge	Burton-on-Trent	
Burton Library	Riverside	Burton upon Trent	Staffordshire
Swadlincote Library	Civic Way	Swadlincote	
Green Bank Leisure Centre	Civic Way	Swadlincote	Derbyshire
Swadlincote Nisa & Post Office	51 Bretby Rd	Newhall	Swadlincote
Stapenhill Tesco Express	Sycamore Road	Stapenhill	Swadlincote

2. Copy of Poster



Section 47(6) Planning Act 2008

Notification of Statement of Community Consultation for Oaklands Farm Solar Project

Notice publicising a Statement of Community Consultation

Oaklands Farm Solar Limited (a wholly owned subsidiary of BayWa r.e. UK Ltd) (BayWa) has published a Statement of Community Consultation (SoCC) in accordance with Section 47(6) of the Planning Act 2008 (as amended by section 134 of the Localism Act 2022) (the Act).

BayWa is seeking a Development Consent Order (DCO) for the development of Oaklands Farm Solar in South Derbyshire. A DCO is required due to the Project's potential generating capacity of over 50MW, and its classification as a Nationally Significant Infrastructure Project (NSIP).

The DCO would authorise the construction, operation and maintenance of a 103MW solar farm and 37.5MW energy storage facility on land between Walton on Trent and Rosliston, South Derbyshire, along with all associated infrastructure including a grid connection at the former Drakelow power station.

The Project is an Environmental Impact Assessment (EIA) development therefore an Environmental Statement (ES) will accompany the application to the Planning Inspectorate.

The Applicant has a duty to consult with local communities before the application is submitted to the Planning Inspectorate. The Applicant is also required to produce a Consultation Report detailing how the public's views have been taken into consideration and how the consultation requirements of the Act have been complied with. The SoCC sets out how BayWa will consult local communities, residents, businesses and organisations in the vicinity of the Project and all associated infrastructure.

Following publication of the SoCC, BayWa will undertake a statutory period of consultation and invite comments on the Project between the 21st April 2022 and 6th June 2022

The SoCC is available for inspection, free of charge as follows:

- On the Project website: www.baywa-re.co.uk/en/solar/oaklands-solar-farm
- In hard copy format at the following locations:

Location	Opening Times**
Swadlincote Library and Information Centre	Monday: 9.30am - 5pm Tuesday: 9.30am - 5pm
Address: Swadlincote Library, Civic Way, Swadlincote	Wednesday: 9.30am - 5pm Thursday: 9.30am - 7pm
Derbyshire DE11 0AD	Friday: 9.30am - 5pm Saturday: 9.30am - 4pm
Email: swadlincote.library@derbyshire.gov.uk	Sunday: Closed

Barton Under Needwood Community Library	Monday: 10am - 12pm / 2pm - 5pm Tuesday: Closed
Address: Barton Under Needwood Library, Durnstall Road	Wednesday: 10am - 12pm / 2pm - 5pm Thursday: 10am - 12pm / 2pm - 5pm
Barton-under-Needwood, Staffordshire DE13 8AX	Friday: 10am - 2pm Saturday: 10am - 1pm
Email: barton.library@staffordshire.gov.uk	Sunday: Closed

Burton Library	Monday: 9am - 6pm Tuesday: 9am - 6pm
Address: Burton Library, Hiverside, Burton upon Trent, Staffordshire DE14 1AH	Wednesday: 9am - 9pm Thursday: 9am - 7pm
Email: burton.library@staffordshire.gov.uk	Friday: 9am - 5pm Saturday: 8.30am - 4.30pm
	Sunday: Closed

**The opening times of these organisations are dependent on and are governed by their own rules and may be subject to change. Covid restrictions may apply.

Public information Days during statutory consultation

We are interested in hearing your views on the Project and will be undertaking formal (statutory) consultation between 21st April 2022 and 6th June 2022. We will be holding public consultation events during the consultation period where members of the project team will be available to discuss the proposals and answer any questions you may have. Materials including maps, visual aids and explanatory information will be available for review and comment during the consultation dates set out above. Exhibitions will take place at the following dates and locations:

Walton on Trent Village Hall 34 Main St, Walton-on-Trent, Swadlincote, DE12 8LZ	Rosliston & Cauldwell Village Hall Main Street, Rosliston, Swadlincote, Derbyshire, DE12 8JW
Friday 6th May 2022 - 1pm to 7pm	Saturday 7th May 2022 - 12noon to 4pm

How to have your say

Details of the statutory consultation and how to be involved are set out in the SoCC. Please note; consultation documents will only be available from the start of the consultation on 21st April 2022. Any responses or representations in respect of the Project can be made during the consultation period via the feedback form (available at events, above noted locations, on the project website and upon request) or in writing via:

- Email – info.oaklands-solarfarm@baywa-re.co.uk
 - Feedback forms – available online via the project website (www.baywa-re.co.uk/en/solar/oaklands-solar-farm) and consultation events. Alternatively, get in touch to request a hard copy and we will post it to you
 - Freepost – FREEPOST TC CONSULTATION (no further address or stamp required)
 - Virtual Exhibition - accessible via: www.baywa-re.co.uk/en/solar/oaklands-solar-farm
- If you have any queries about the consultation process you can call 0800 699 0081 (Freephone - Monday to Friday 9am to 5pm excluding public holidays)

The deadline date for comments is 11.59pm 6th June 2022

Should the SoCC or associated documents be required in a different format (e.g. large text), please contact the Applicant using any of the methods above.

3. Example photos of posters in situ

Stapenhill Tesco Express



The Co-Operative Food, Barton Under Needwood

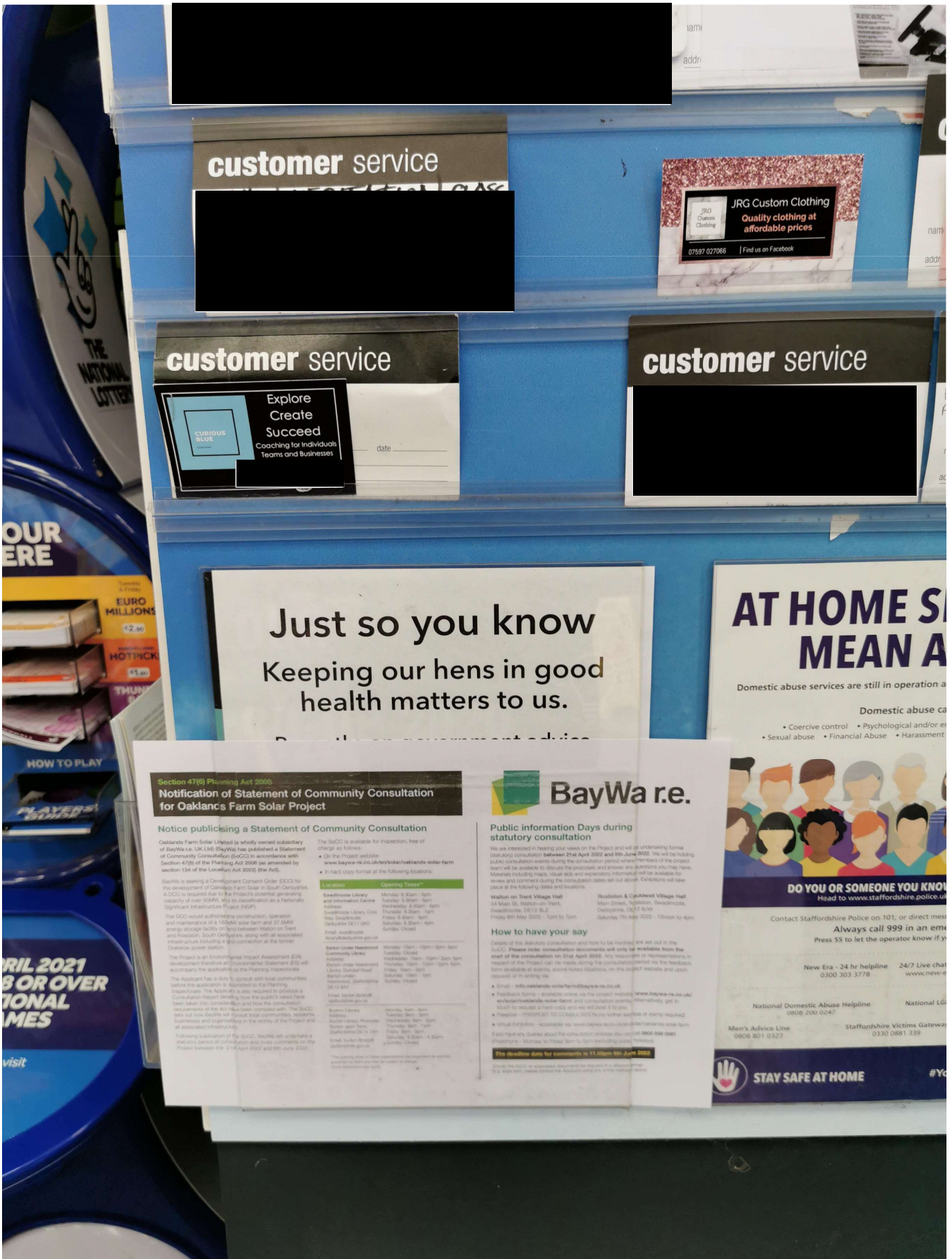

customer service

JRG Custom Clothing
Quality clothing at affordable prices
07957 027066 | Find us on Facebook

customer service

Explore Create Succeed
Coaching for Individuals Teams and Businesses
curious BLUE

customer service

Just so you know
Keeping our hens in good health matters to us.

AT HOME S
MEAN A

Domestic abuse services are still in operation a

Domestic abuse ca

- Coercive control
- Psychological and/or e
- Sexual abuse
- Financial Abuse
- Harassment

Section 47(6) Planning Act 2008
Notification of Statement of Community Consultation for Oaklands Farm Solar Project

Notice publicising a Statement of Community Consultation

Oaklands Farm Solar Limited (a wholly owned subsidiary of BayWa r.e. UK Ltd (BayWa)) has published a Statement of Community Consultation (SCCC) in accordance with Section 47(6) of the Planning Act 2008 (as amended by section 134 of the Localism Act 2011) (the Act).

BayWa is seeking a Development Consent Order (DCO) for the development of Oaklands Farm Solar in South Derbyshire. A DCO is required due to the Project's potential generating capacity of over 50MW, and its classification as a Nationally Significant Infrastructure Project (NSIP).

The DCO would authorise construction, operation and maintenance of a 163MW solar farm and 37 MW energy storage facility on land between Walton on Trent and Needwood, South Derbyshire, along with all associated infrastructure including a 66kV connection at the former Derbyshire power station.

The Project is an Environmental Impact Assessment (EIA) developer therefore an Environmental Statement (ES) will accompany the application to the Planning Inspectorate. The Applicant is also required to submit a Consultation Report detailing how the public's views have been taken into consideration and how the consultation requirements of the Act have been complied with. The SCCC sets out how BayWa will engage local communities, residents, businesses and organisations in the vicinity of the Project and all associated infrastructure.

Following publication of the SCCC, BayWa will undertake a statutory period of consultation and make comments on the Project between the 11 April 2022 and 09 June 2022.

The SCCC is available for inspection, free of charge as follows:

- On the Project website: www.baywa-re.co.uk/en/sector/oaklands-solar-farm
- In hard copy format at the following locations:

Location	Opening Times*
Needwood Library and Information Service Address: Needwood Library, Oak Way, Needwood, Derbyshire DE1 1 0AD Email: enquiries@needwood.gov.uk	Monday 9:30am - 5pm Tuesday 9:30am - 5pm Wednesday 9:30am - 5pm Thursday 9:30am - 5pm Friday 9:30am - 5pm Saturday 9:30am - 5pm Sunday Closed
Barton Under Needwood Community Library Address: Barton Under Needwood Library, Church Road, Barton-under-Needwood, Derbyshire DE1 2 8AQ Email: library@barton-under-needwood.gov.uk	Monday 10am - 10pm Tuesday 10am - 10pm Wednesday 10am - 10pm Thursday 10am - 10pm Friday 10am - 10pm Saturday 10am - 10pm Sunday Closed
Walsley Library Address: Walsley Library, Walsley, Derbyshire DE11 1 1JG Email: enquiries@walsley.gov.uk	Monday 9:30am - 5pm Tuesday 9:30am - 5pm Wednesday 9:30am - 5pm Thursday 9:30am - 5pm Friday 9:30am - 5pm Saturday 9:30am - 5pm Sunday Closed
Walsley Library Address: Walsley Library, Walsley, Derbyshire DE11 1 1JG Email: enquiries@walsley.gov.uk	Monday 9:30am - 5pm Tuesday 9:30am - 5pm Wednesday 9:30am - 5pm Thursday 9:30am - 5pm Friday 9:30am - 5pm Saturday 9:30am - 5pm Sunday Closed

*The opening times of these consultation points may be subject to change. Please check the Project website for the most up-to-date information.

BayWa r.e.

Public information Days during statutory consultation

We are interested in hearing your views on the Project and will be undertaking formal statutory consultation between 21st April 2022 and 09th June 2022. We will be holding public consultation events during the consultation period where members of the project team will be available to discuss the proposal and answer any questions you may have. Materials including maps, visual aids and explanatory information will be available for review and comment during the consultation days set out above. BayWa will take place at the following dates and locations:

Location	Dates and Times
Walton on Trent Village Hall 24 Main St, Walton-on-Trent, Leicestershire, DE12 8LZ Friday 09th May 2022 - 10am to 5pm	10am to 5pm
Needwood & Cankwell Village Hall Main Street, Needwood, Leicestershire, DE12 8JW Saturday 16th May 2022 - 10:30am to 4pm	10:30am to 4pm

How to have your say

Details of the statutory consultation and how to be involved are set out in the SCCC. Please note: consultation documents will only be available from the start of the consultation on 21st April 2022. Any responses or representations in respect of the Project can be made during the consultation period via the feedback form available at events, above noted locations, on the project website and upon request or in writing via:

- Email - info.oaklands-solar@baywa-re.co.uk
- Feedback forms - available online via the project website (www.baywa-re.co.uk/en/sector/oaklands-solar-farm) and consultation evening/forums/events, get a form to request a hard copy and we will post it to you.
- Feedback - RESPOND TO US AND CONTACT US further advice or help is required.
- Virtual Engagement - accessible via www.baywa-re.co.uk/en/sector/oaklands-solar-farm

If you have any queries about the consultation please call 0800 090 000 (Monday - Monday 9am to 5pm excluding public holidays)

The deadline date for comments is 11:59pm on 09th June 2022.

Once the SCCC or associated documents are published in a statutory form (e.g. Highways Act), please contact the applicant using any of the contact details.

DO YOU OR SOMEONE YOU KNOW
Head to www.staffordshire.police.uk

Contact Staffordshire Police on 101, or direct message Always call 999 in an emergency Press 55 to let the operator know if you are deaf or hearing impaired

New Era - 24 hr helpline 0300 303 3778 24/7 Live chat www.new-era.org.uk

National Domestic Abuse Helpline 0808 200 0247 National LG

Men's Advice Line 0808 801 0322 Staffordshire Victims Gateway 0330 0881 339

STAY SAFE AT HOME #Yo



Tesco Superstore – Burton on Trent



Barton Under Needwood Community Library

